

58/15 Jumbuck Crescent Lawson ACT

2  1  1 

Enjoy the space this property has to offer with lots of internal living space & an additional courtyard & balcony area for your added leisure. This home features an abundance of natural light & warmth throughout. The contemporary kitchen boasts quality inclusions such as a gas cooktop, dishwasher, stone benchtops & soft close drawers & cupboards. All bedrooms are generous in size & feature LED downlights, built-in mirrored sliding robes with adjustable shelving.

Features:

- 2 bedrooms, both carpeted & with large built in robes
- Open plan living
- Great sized kitchen with gas cooktop & dishwasher
- Expansive open plan lounge & dining space

Type : Townhouse

View : <https://www.ruizproperty.com.au/lease/act/belconnen/lawson/residential/townhouse/8096179>

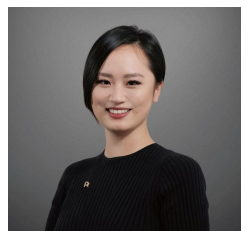

Kaylee Wang
02 6109 7667

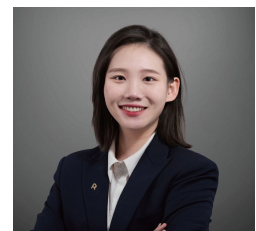

Gloria Luo
02 6109 7667

[For full version visit the website](https://www.ruizproperty.com.au)



GROUND FLOOR

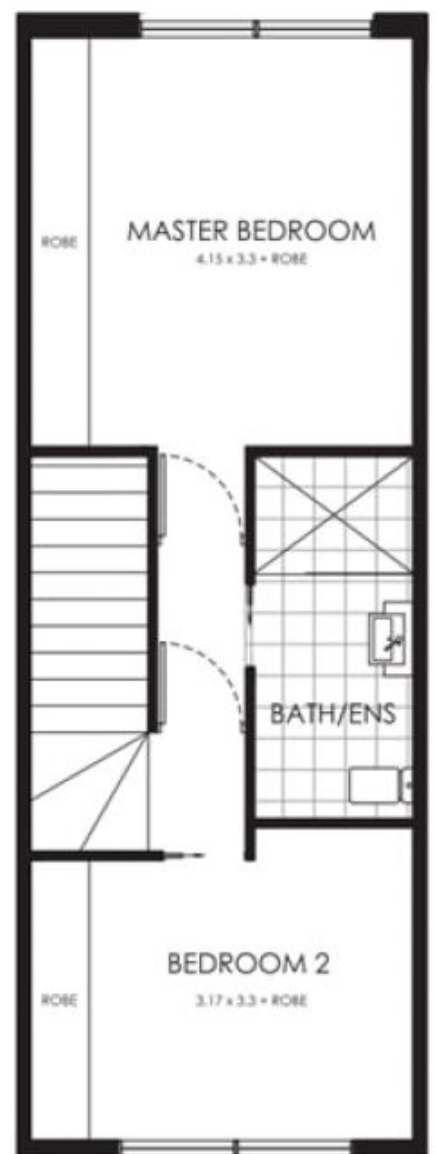

UPPER FLOOR